

# Montageanleitung · Mounting instructions

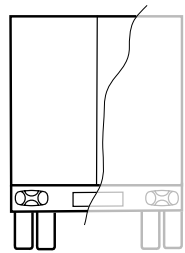

LINKS - LEFT

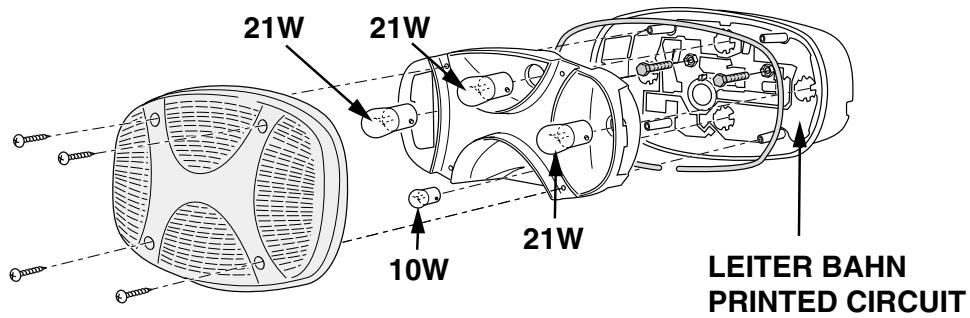
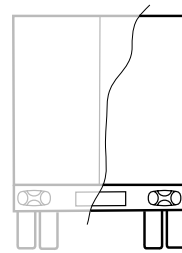

RECHTS - RIGHT

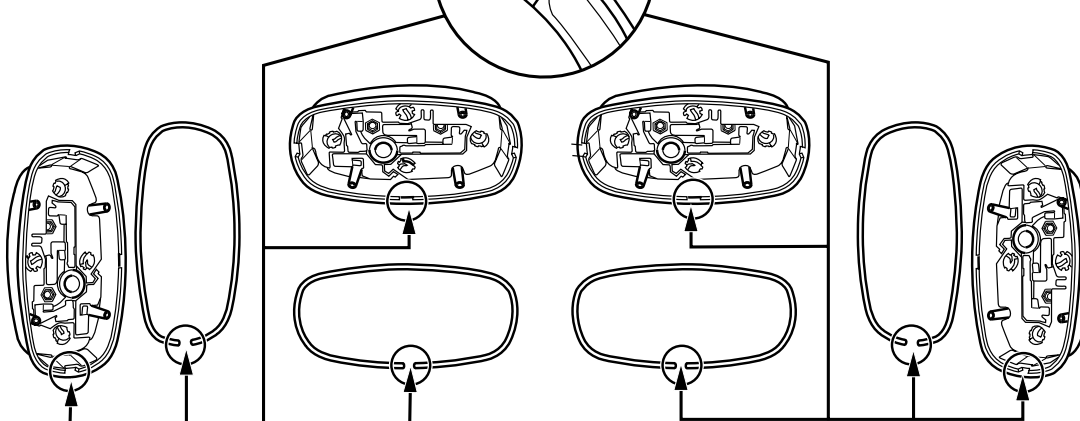
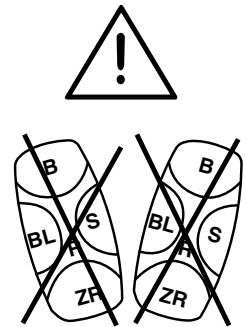
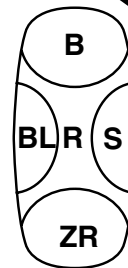
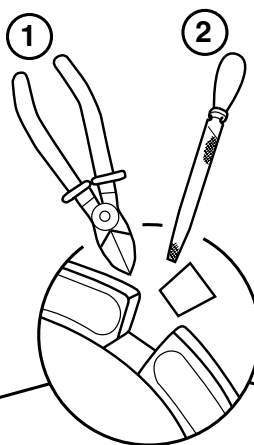
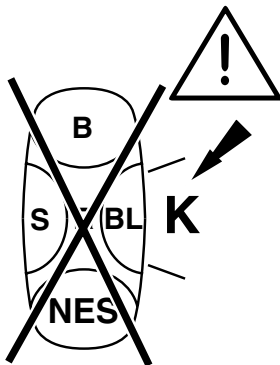
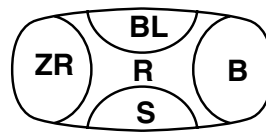
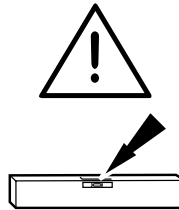
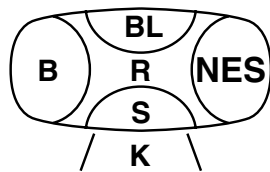

## LINKS - LEFT

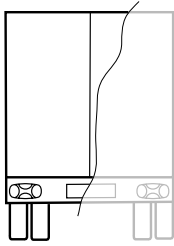

## RECHTS - RIGHT

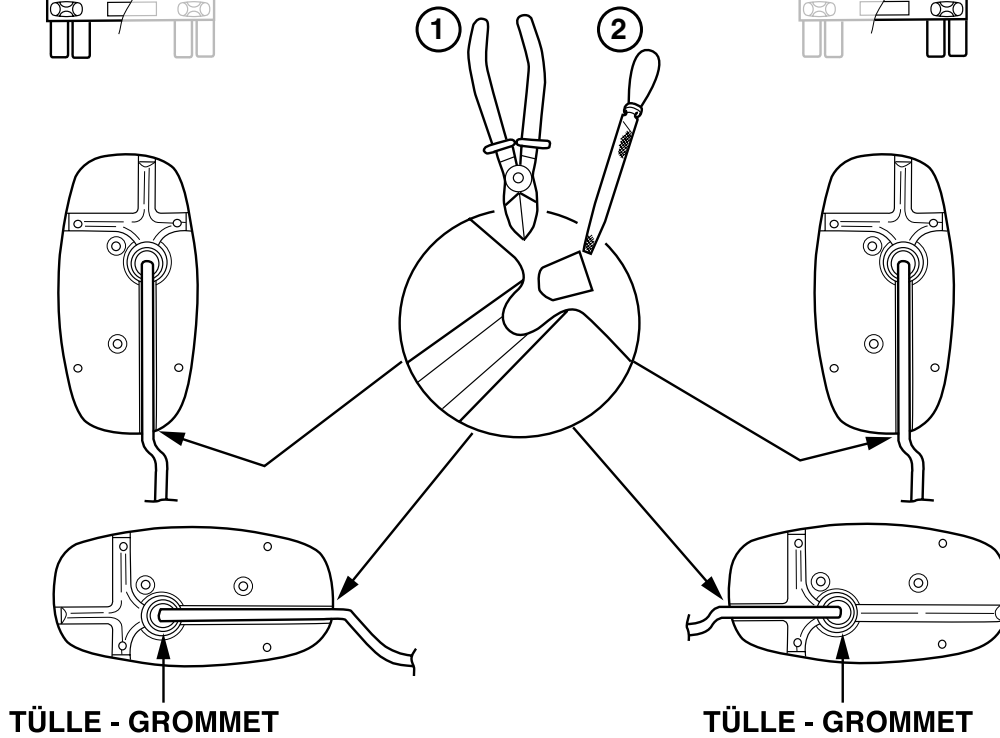
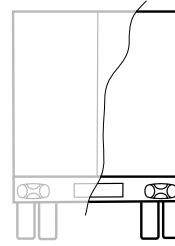

### TABELLE FÜR FUNKTION - TABLE OF FUNCTIONS

31	=	MASSE / EARTH
54/B	=	BREMSLICHT / BRAKE LIGHT
58L/S	=	SCHLUSSLICHT LINKS / TAIL LIGHT LEFT
L/BL	=	BLINKLICHT LINKS / TURN IND. LIGHT LEFT
K	=	KENNZEICHENLICHT / NUMBER PLATE LIGHT

31	=	MASSE / EARTH
54G/NES	=	NEBELSCHLUSSLICHT / FOG LIGHT
58R/S	=	SCHLUSSLICHT RECHTS / TAIL LIGHT RIGHT
R/BL	=	BLINKLICHT RECHT / TURN IND. LIGHT RIGHT
ZR	=	RÜCKFAHRLICHT / REVERSING LIGHT

### LEITERBAHN - PRINTED CIRCUIT

